



# 2634, 2636, 2640, 2642 & 2654 EGLINTON AVENUE WEST AND 1856 & 1856A KEELE STREET

## APPLICATION FOR ZONING BY-LAW AMENDMENT AND SITE PLAN APPROVAL

### PROJECT TEAM

**DEVELOPER**  
FORA DEVELOPMENTS  
T: 416-536-3600  
www.foradevelopments.com

**ARCHITECTURAL & LANDSCAPE ARCHITECTURE**  
gh3\*  
T: 416-915-1791  
www.gh3.ca

**PLANNING & URBAN DESIGN**  
BOUSFIELDS INC.  
T: 416-322-6364  
www.bousfields.ca

**CIVIL ENGINEERING**  
IBI GROUP  
T: 416-596-1930  
www.ibigroup.com

**ARBORIST**  
CENTRAL TREE CARE  
T: (416) 285-4750  
www.centraltreecare.net

**WIND**  
SLR CONSULTING  
www.slrconsulting.com

**TRANSPORTATION**  
BA GROUP  
T: 416-961-7110  
www.bagroup.com

**STRUCTURAL**  
HONEYCOMB STRUCTURAL ENGINEERS  
T: 647-833-7520  
www.honeycombgroup.ca/

**MECHANICAL & ELECTRICAL**  
MCW CONSULTANTS LTD.  
T: 416-596-2920  
www.mcw.com

### LANDSCAPE SHEET LIST

Sheet Number	Sheet Name	Current Revision	Revision Date
L0.00	COVER SHEET		
L0.01	TREE PROTECTION PLAN	2	Oct.6.22
L1.01	LANDSCAPE & PLANTING PLAN	3	Oct.26.22
L1.02	L4 LANDSCAPE & PLANTING PLAN	3	Oct.26.22
L1.03	LANDSCAPE ROOF PLAN		
L4.01	LANDSCAPE DETAILS		
LE1.01	GROUND FLOOR LIGHTING PLAN	2	Oct.6.22
LE1.02	L4 FLOOR LIGHTING PLAN	3	Oct.26.22
LE1.03	L7 FLOOR LIGHTING PLAN	3	Oct.26.22

Copyright is that of the Architect. Any version of this drawing reproduced by any means from any media without prior written approval of the Architect is to be used for information only. The Architect will not be liable for any loss or disturbance of information resulting from subsequent reproduction of the original drawing.

**GENERAL NOTES:**

- Drawings are not to be scaled. Contractor will verify all existing conditions and dimensions required to perform the Work and will report any discrepancies with the Contract Documents to the Architect before commencing work.
- The Architect's Drawings are to be read in conjunction with all other Contract Documents, including the Project Manual and the Structural, Mechanical and Electrical Drawings. In case of difference between the Contract Documents with respect to the quantity, location or work, the greater shall apply.
- Positions of required fire-rated Mechanical or Electrical ducts, pipes, and fixtures are indicated on the Architectural Drawings. Locations shown on the Architectural Drawings shall govern over Mechanical and Electrical Drawings. Mechanical and Electrical items not clearly located will be located and detailed by the Architect.
- Dimensions indicated are taken between the faces of member surfaces unless otherwise noted.
- The Architect has not been retained for supervision of construction and assumes no responsibility for means, methods and sequence of construction.
- These documents are not to be used for construction unless specifically noted for such purpose.

Rev. Date Sheet

**gh3\***  
ghp  
45 EGLINTON AVE. SUITE 100  
TORONTO, ON. CANADA M5G 2P9  
416 915 1791

**FORA**  
FORA  
2634, 2636, 2640, 2642 &  
2654 EGLINTON AVENUE  
WEST AND 1856 & 1856A  
KEELE STREET

TORONTO, ONTARIO

SCALE  
PROJECT NO. 202002  
ISSUE DATE DEC. 8, 2022

**COVER SHEET**

**L0.00**

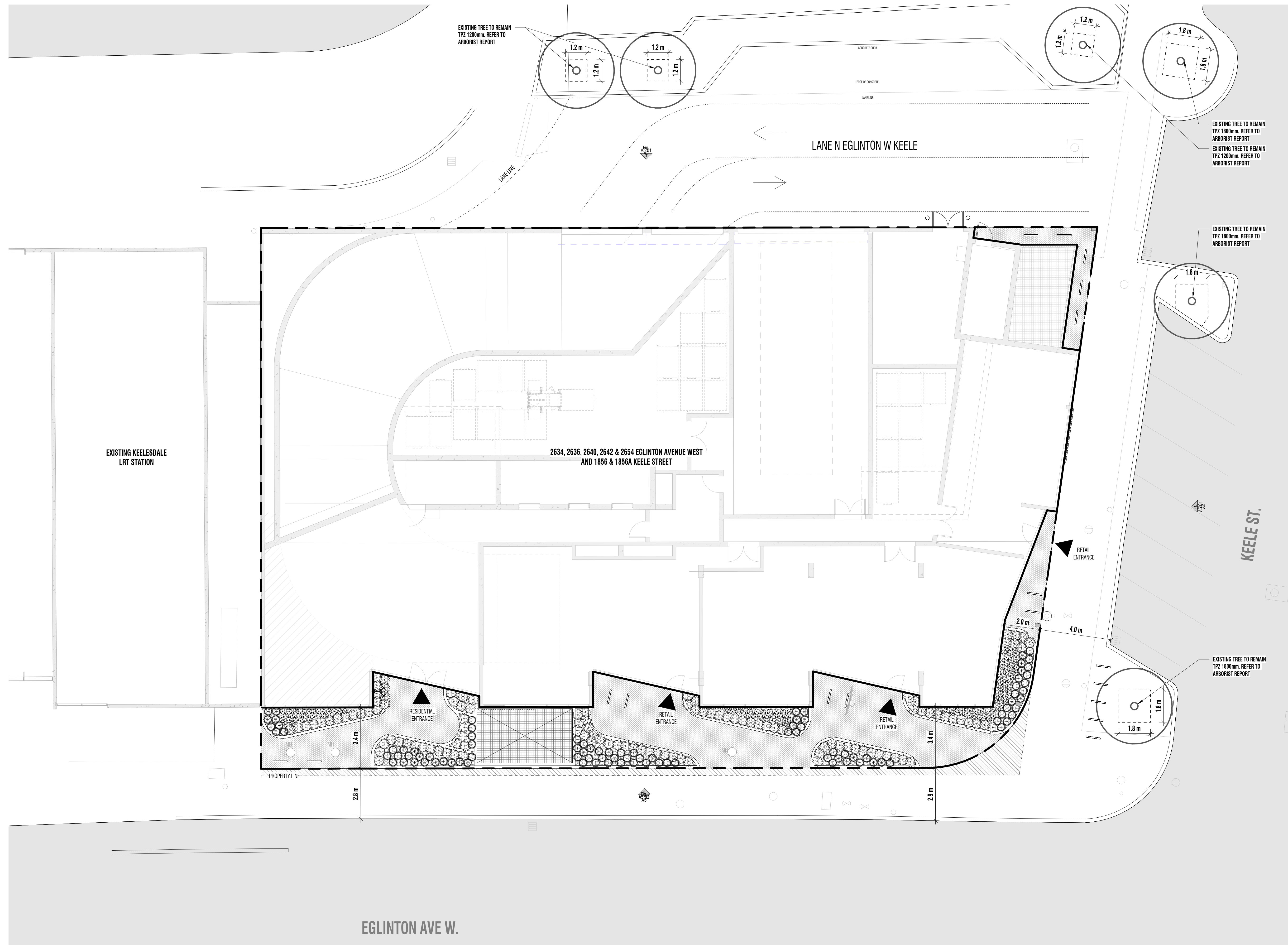

1 Level 1 ZBA - TREE PROTECTION PLAN  
 LO.01 1:100

Tree Inventory

Table 1. The visual inspection from the ground only was completed on June 16, 2022. The location of trees marked with asterisk was approximated on the TPP; if there are any disputes regarding the location of the tree then an official survey should be conducted.

#	Species	Latin Name	DBH (cm)	TPH (m)	Health	Structure	Assessment	Comment	Category
1	Honey Locust	<i>Gleditsia triacanthos</i>	15.5	1.8	Good	Fair Good	Codominant 2m above grade with included union and vertical seam. Epicormic growth present throughout canopy. Growing on slight lean. Slightly asymmetrical canopy. Minor deadwood and dieback present.	Fully protected	5
2	Kentucky Coffeetree	<i>Gymnocladia dioica</i>	6	1.2	Good	Fair Good	Overall healthy. Codominant 2m above grade. Growing on slight lean.	Fully protected	5
3	Honey Locust	<i>Gleditsia triacanthos</i>	26	1.8	Fair Good	Fair Good	Multistem 2m above grade, Root flare present. Thick grass around base. Epicormic growth present throughout canopy. Limb failure, 7cm in diameter above sidewalk. Minor deadwood. 30% canopy. Canopy ~70 full for healthy tree, slightly sparse	Fully protected	5
4	Honey Locust	<i>Gleditsia triacanthos</i>	18	1.8	Fair	Fair	Planted too high, maintain wound 1m above grade with decay present, 40% circumference of mainstem, reaction wood present. History of pruning, lifted 3m above grade sealing well. 30% deadwood. 60% canopy, slightly sparse. Epicormic growth present throughout canopy. Lower, mid canopy minor dieback, 10% of canopy. Growing on slight lean.	Fully protected	5
5	Freeman maple	<i>Acer x freemanii</i>	7	1.2	Fair Good	Fair Good	Growing on slightly lean. Slightly asymmetrical canopy. Epicormic growth present within canopy. Canopy dieback present. Small deadwood present. ~80% canopy	Unregulated under TPPR	2
6	Red oak	<i>Quercus rubra</i>	7	1.2	Fair Poor	Fair	Significant epicormic growth. Growing on slight lean. Buried root flare. 50% original canopy deceased or dying back, most of canopy consisting of epicormic growth. Canopy sparse overall.	Unregulated under TPPR	2

7	Red Oak	<i>Quercus rubra</i>	7	1.2	Fair Good	Fair Good	Epicormic growth present within canopy. Slightly sparse canopy. 80% original canopy healthy. Buried root flare.	Unregulated under TPPR	2
8	European buckthorn	<i>Rhamnus cathartica</i>	~6	1.2	Fair Good	Fair Poor	Growing from crack in asphalt against existing building. Overall healthy. Naturally seeded.	Unregulated under TPPR	1
9	Tree of heaven	<i>Ailanthus altissima</i>	~7	1.2	Good	Fair Poor	Growing from crack in asphalt against existing building. Overall healthy. Naturally seeded.	Unregulated under TPPR	1
10	Mantoba maple	<i>Acer negundo</i>	~2	1.2	Fair	Fair Poor	Previously topped, canopy consist of epicormic growth. Growing from crack in asphalt between building. Naturally seeded.	Unregulated under TPPR	1
11	Mulberry	<i>Morus alba</i>	~5	1.2	Good	Fair	Growing from crack in asphalt, growing close to existing building. Overall healthy. Naturally seeded.	Unregulated under TPPR	1
12	European buckthorn	<i>Rhamnus cathartica</i>	~3	1.2	Good	Fair	Growing from crack in asphalt, growing close to building. Overall healthy. Naturally seeded. Nighthade vine growing around stem and canopy.	Unregulated under TPPR	1

- Category #:
- Trees with diameters of 30cm or more, situated on private property on the subject site.
  - Trees with diameters of 30cm or more, situated on private property, within 6m of subject site.
  - Trees of all diameters situated on City owned parkland within 6m of subject site.
  - Trees of all diameters situated within lands designated under City of Toronto Municipal Code, Chapter 638, Ravine Protection.
  - Trees of all diameters situated within the City road allowance adjacent to the subject site.

Recommendations for tree protection installation:

Tree protection hoarding installation specifications are outlined by the City of Toronto within the "Tree Protection Policy and Specifications for Construction Near Trees" document which can be accessed at <https://www.tbn.ca/wp-content/uploads/Toronto-Tree-Protection-Policy.pdf>

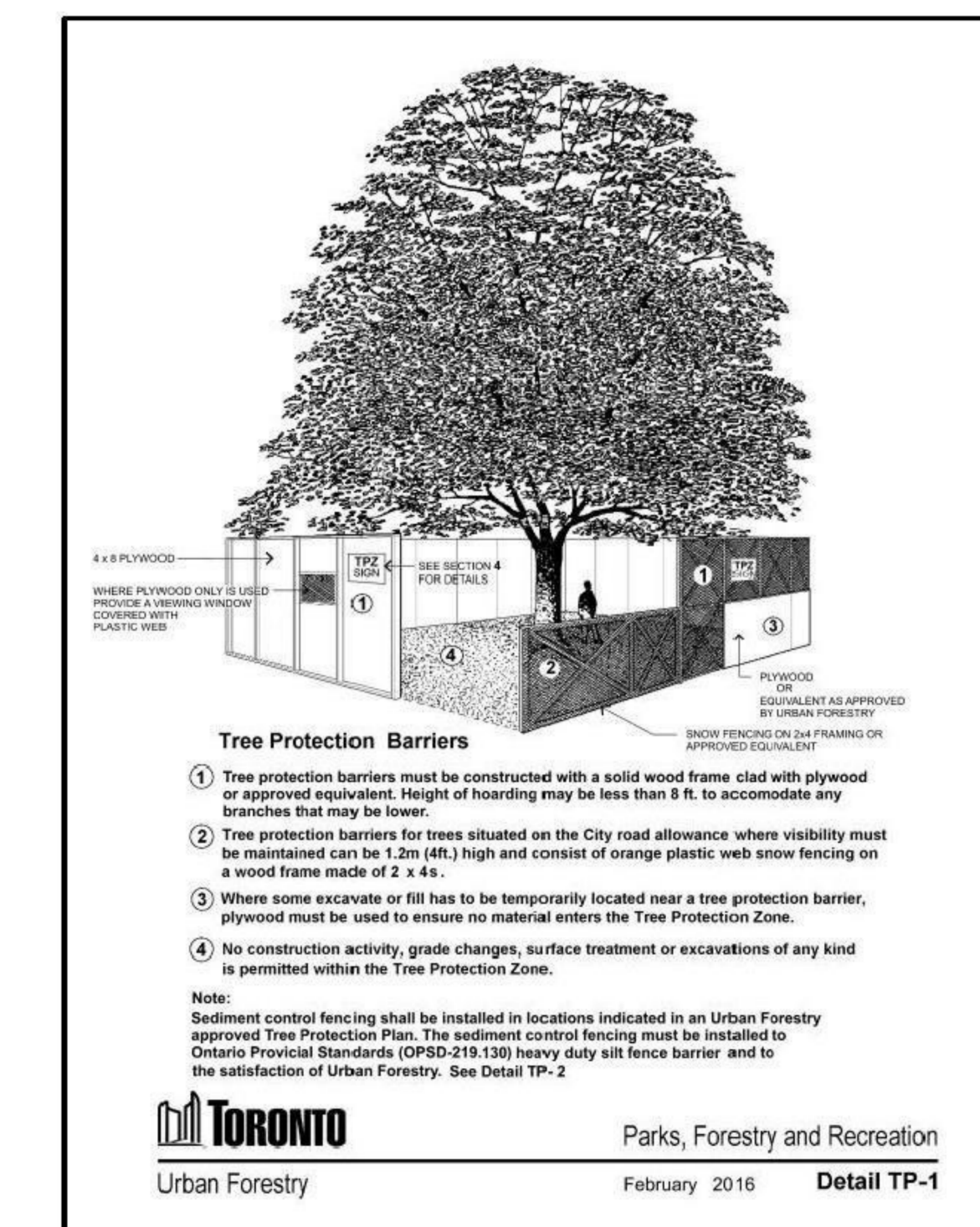

Tree Protection Barriers

- Tree protection barriers must be constructed with a solid wood frame, clad with plywood or approved equivalent. Height of hoarding may be less than 1.8m, depending on the height of the tree.
- Tree protection barriers for trees situated on the City road allowance, where visibility must be maintained can be 2.0m (6ft) high and consist of orange plastic web snow fencing on a wood frame made of 4x4.
- Where some excavate or fill has to be temporarily located near a tree protection barrier, ground must be used to ensure no material enters the Tree Protection Zone.
- No construction activity, grade changes, surface treatment or excavations of any kind is permitted within the Tree Protection Zone.

Note: Supplemental control barriers shall be installed in locations indicated in an Urban Forestry approved Tree Protection Plan. The supplemental control fencing must be installed to Urban Forestry Standards (UFS) 218 every day with fence barrier and in the satisfaction of Urban Forestry. See Detail TP\_2

Copyright is that of the Architect. Any content of this drawing reproduced by any means from any media without the written approval of the Architect is to be used for information only. The Architect will not be liable for any loss or disturbance of information resulting from subsequent reproduction of the original drawing.

GENERAL NOTES:  
 1. Drawings are not to be scaled. Contractors will verify all existing conditions and dimensions prior to perform the Work and will report any discrepancies with the Contract Documents to the Architect before commencing work.  
 2. The Architect's Drawings are to be read in conjunction with all other Contract Documents including the Project Manual and the Standard Specifications and Technical Drawings. In case of difference between the Contract Documents with respect to the quantity, location or nature of work, the greater shall apply.  
 3. Positions of existing or located Mechanical or Electrical ductwork, piping, and fixtures are indicated on the Architectural Drawings. Locations shown on the Architectural Drawings shall govern over Mechanical and Electrical Drawings. Mechanical and Electrical items not clearly located will be located as directed by the Architect.  
 4. Dimensions indicated on plans between the faces of existing surfaces unless otherwise noted.  
 5. The architect has not been retained for representation of construction and is not responsible for means, methods and sequence of construction.  
 6. These documents are not to be used for construction unless specifically noted for such purpose.

3

4

5

6

7

gh3\*  
 2534, 2636, 2640, 2642 & 2654 EGLINTON AVENUE WEST AND 1856 & 1856A KEELE STREET  
 TORONTO, ONTARIO  
 SCALE 1:100  
 PROJECT NO. 202022  
 ISSUE DATE DEC. 8, 2022  
 TREE PROTECTION PLAN  
 LO.01

Copyright © 2022 of the Architect. Any version of this drawing reproduced by any means from any media without prior written approval of the Architect is to be used for information only. The Architect is not liable for any loss or disturbance of information resulting from subsequent reproduction of the original drawing.

**GENERAL NOTES:**

- Drawings are not to be scaled. Contractor will verify all existing conditions and dimensions required to perform the Work and will report any discrepancies with the Contract Documents to the Architect before commencing work.
- The Architectural Drawings are to be read in conjunction with all other Contract Documents including the Project Manual and the Schedule of Materials and Electrical Drawings. In cases of difference between the Contract Documents with respect to the quantity, location or nature of work, the greater shall apply.
- Positions of existing or proposed Mechanical or Electrical Ductwork, Piping, and Risers are indicated on the Architectural Drawings. Locations shown on the Architectural Drawings shall govern over Mechanical and Electrical Drawings. Mechanical and Electrical items not clearly located will be located as directed by the Architect.
- Dimensions indicated are taken between the faces of finished surfaces unless otherwise noted.
- The Architect has not been retained for supervision of construction or assurance of compliance with relevant, applicable laws and regulations or code.
- These documents are not to be used for construction unless specifically noted for such purposes.

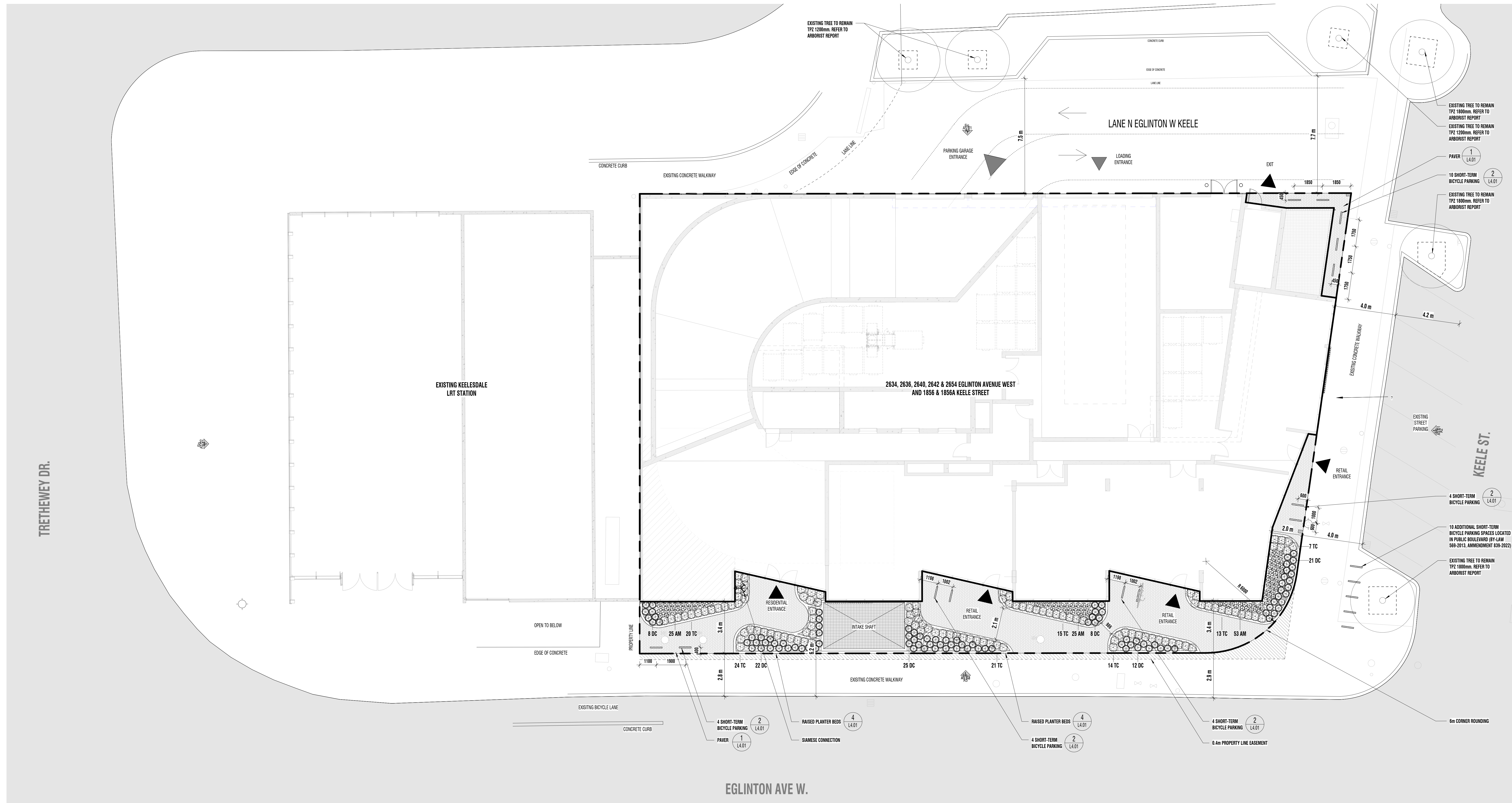

1 Level 1 ZBA - LANDSCAPE  
L1.01 1:100

**PLANTING - PERENNIALS**

TAG	COMMON NAME	BOTANICAL NAME	Size	CONDITION	QTY	REMARKS
AM	WHITE YARROW	ACHILLEA MILEFOLIUM	1 GAL.	CONT.	103	300mm O.C. DROUGHT TOLERANT; NATIVE SPECIES
DC	TUFTED HAIR GRASS	DESCHAMPSIA CESPIIOSA	2 GAL.	ALL	96	450mm O.C. DROUGHT TOLERANT; NATIVE SPECIES
TC	CANADA YEW	TAXUS CANADENSIS	2 GAL.	CONT.	114	450mm O.C. DROUGHT TOLERANT; NATIVE SPECIES
<b>LEVEL 4 (AMENITY)</b>						
TC	CANADA YEW	TAXUS CANADENSIS	2 GAL.	CONT.	190	450mm O.C. DROUGHT TOLERANT; NATIVE SPECIES
						503

**HARDSCAPE AREAS**

TYPE	AREA	REMARKS
Pavers	283.60 m <sup>2</sup>	SRI > 28; UNILOCK 3' X 12' PERMEABLE PAVER, ECO-PROMENADE, 'OPAL BLEND'
Terrace Pavers	401 m <sup>2</sup>	SRI > 28; UNILOCK 24' X 24' PAVER, ARCANIA, 'CORVARA'
	508 m <sup>2</sup>	
<b>TOTAL</b>	<b>508 m<sup>2</sup></b>	

**SOFTSCAPE AREAS**

TYPE	AREA
LEVEL 1 PLANTING BED	53 m <sup>2</sup>
LEVEL 4 (AMENITY) PLANTING BED	52 m <sup>2</sup>
Mech. PH R1-A 150 LIVE GREEN ROOF	416 m <sup>2</sup>
Roof R1-A 150 LIVE GREEN ROOF	79 m <sup>2</sup>
<b>TOTAL</b>	<b>600 m<sup>2</sup></b>

HIGH-ALBEDO PAVERS  
 SRI VALUE: 29 OR BETTER  
 CONCRETE PAVING  
 SRI VALUE: 29 OR BETTER  
 CONCRETE PAVING  
 SRI VALUE: 29 OR BETTER

Rev.	Date	Issued
3	Oct. 26, 22	Coordination
2	Oct. 6, 22	Coordination
1	Sept. 29, 22	Coordination

**gh3\***  
 gh3  
 45 EGLINTON AVE. SUITE 100  
 TORONTO, ON. CANADA M5P 2P9  
 416 915 1191

**FORA**  
 FORA  
 2634, 2636, 2640, 2642 &  
 2654 EGLINTON AVENUE  
 WEST AND 1856 & 1858A  
 KEELE STREET

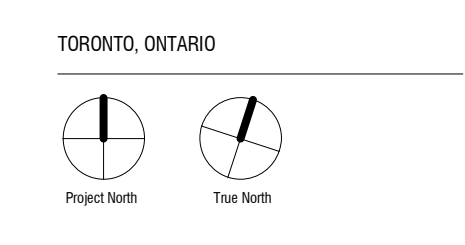

SCALE: As Indicated  
 PROJECT NO.: 202002  
 ISSUE DATE: DEC. 8, 2022

**LANDSCAPE & PLANTING PLAN**

Copyright is that of the Architect. Any version of this drawing reproduced by any means from any media without prior written approval of the Architect is to be used for information only. The Architect will hold any liability or obligation of information resulting from subsequent reproduction of the original drawing.

**GENERAL NOTES:**

1. Drawings are not to be scaled. Contractor will verify all existing conditions and dimensions required to perform the Work and will report any discrepancies with the Contract Documents to the Architect before commencing work.
2. The Architectural Drawings are to be read in conjunction with all other Contract Documents including the Project Manual and the Division of Mechanical and Electrical Drawings. In case of difference between the Contract Documents with respect to the quantity, location or nature of work, the greater shall apply.
3. Positions of equipment including Mechanical or Electrical Ductwork, Hangers and related are indicated on the Architectural Drawings. Locations shown on the Architectural Drawings shall govern over Mechanical and Electrical Drawings. Mechanical and Electrical items not clearly located will be located as directed by the Architect.
4. Dimensions indicated are taken between the faces of finished surfaces unless otherwise noted.
5. The architect has not been retained for supervision of construction and assumes no responsibility for means, methods and materials of construction.
6. These documents are not to be used for construction unless specifically noted for such purpose.

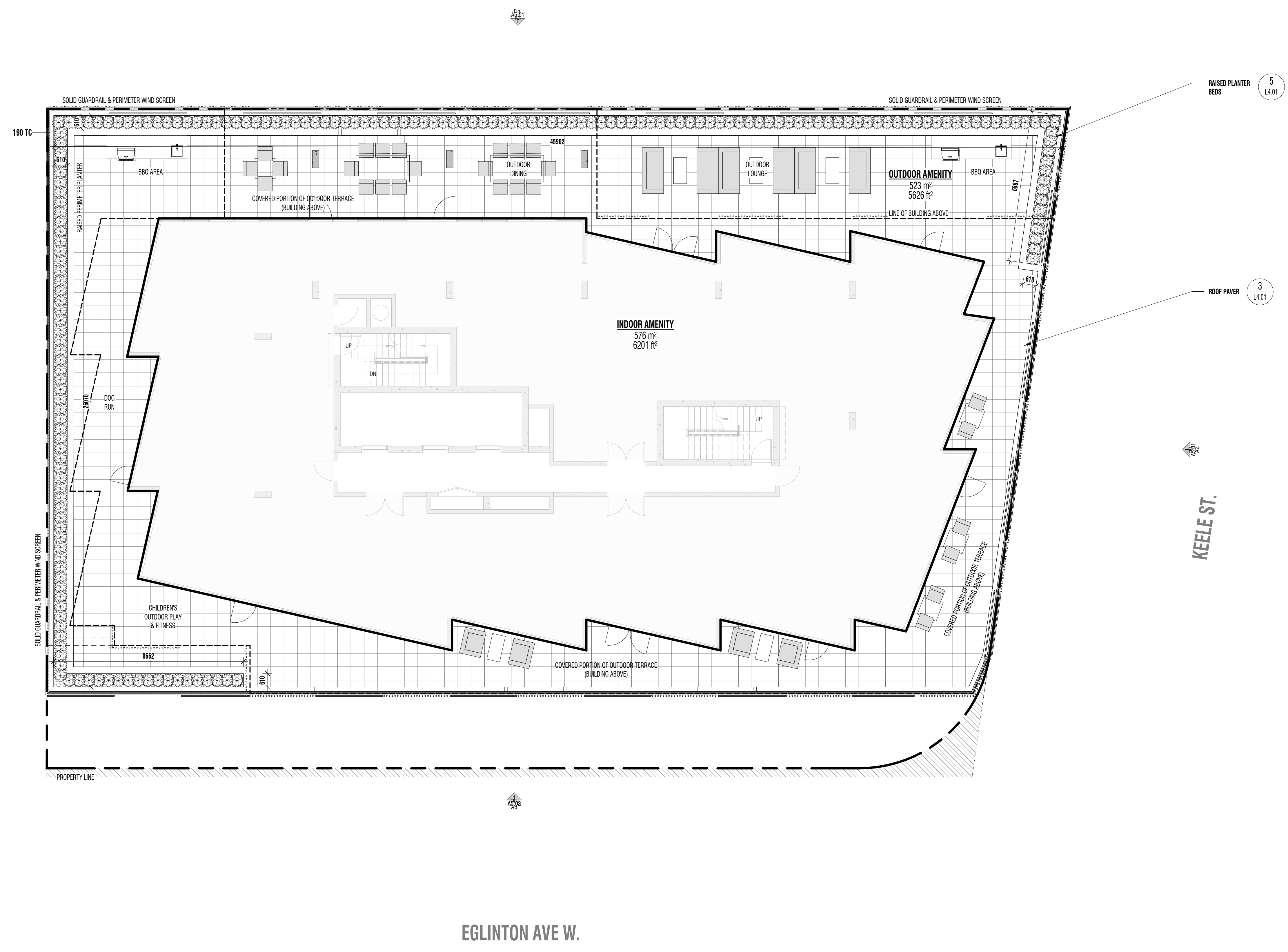

**1** LEVEL 4 (AMENITY) ZBA - LANDSCAPE  
L1.02 1:100

**PLANTING - PERRENIALS**

TAG	COMMON NAME	BOTANICAL NAME	Size	CONDITION	QTY	REMARKS
AM	WHITE YARROW	ACHILLEA MILEFOLIUM	1 GAL.	CONT.	103	300mm O.C. DROUGHT TOLERANT; NATIVE SPECIES
DC	TUFTED HAIR GRASS	DESCHAMPSIA CESPIIOSA	2 GAL.	ALL	96	450mm O.C. DROUGHT TOLERANT; NATIVE SPECIES
TC	CANADA YEW	TAXUS CANADENSIS	2 GAL.	CONT.	114	450mm O.C. DROUGHT TOLERANT; NATIVE SPECIES
<b>LEVEL 4 (AMENITY)</b>						
TC	CANADA YEW	TAXUS CANADENSIS	2 GAL.	CONT.	190	450mm O.C. DROUGHT TOLERANT; NATIVE SPECIES
					503	

**HARDSCAPE AREAS**

LEVEL	TYPE	AREA	REMARKS
LEVEL 1	Pavers	283.69	SRI > 28; UNILOCK 3' X 12' PERMEABLE PAVER, ECO-PROMENADE, 'OPAL BLEND'
LEVEL 4 (AMENITY)	Terrace Pavers	401	SRI > 28; UNILOCK 24' X 24' PAVER, ARCANIA, 'CORVARA'
		508	
<b>TOTAL</b>		<b>508</b>	

**SOFTSCAPE AREAS**

LEVEL	TYPE	AREA
LEVEL 1	PLANTING BED	53 m²
LEVEL 4 (AMENITY)	PLANTING BED	52 m²
Mech. PH	R1-A 150 LIVE GREEN ROOF	416 m²
Roof	R1-A 150 LIVE GREEN ROOF	79 m²
<b>TOTAL</b>		<b>600</b>
		<b>600</b>

HIGH-ALBEDO PAVERS  
 SRI VALUE - 28 OR BETTER  
 CONCRETE PAVING  
 SRI VALUE - 29 OR BETTER  
 CONCRETE PAVING  
 SRI VALUE - 29 OR BETTER

3	Oct. 26.22	Coordination
2	Oct. 6.22	Coordination
1	Sept. 29.22	Coordination
Rev.	Date	Issued

**gh3\***  
 gh3  
 45 EGLINTON AVE. SUITE 100  
 TORONTO, ON. CANADA M4Y 2Y9  
 416 915 1791

**FORA**  
 FORA  
 2634, 2636, 2640, 2642 &  
 2654 EGLINTON AVENUE  
 WEST AND 1856 & 1856A  
 KEELE STREET

TORONTO, ONTARIO

North South

SCALE	As Indicated
PROJECT NO.	20202
ISSUE DATE	DEC. 8, 2022

**L4 LANDSCAPE & PLANTING PLAN**

Copyright © 2022 of the Architect. Any version of this drawing reproduced by any means from any media without prior written approval of the Architect is to be used for information only. The Architect will not be held responsible for any error or omission of information resulting from subsequent reproduction of the original drawing.

**GENERAL NOTES:**

1. Drawings are not to be scaled. Contractor will verify all existing conditions and dimensions required to perform the Work and will report any discrepancies with the Contract Documents to the Architect before commencing work.
2. The Architectural Drawings are to be read in conjunction with all other Contract Documents including the Project Manual and the Structural, Mechanical and Electrical Drawings. In case of difference between the Contract Documents with respect to the quantity, location or nature of work, the greater shall apply.
3. Positions of equipment as located Mechanical or Electrical Drawings, piping and fixtures are indicated on the Architectural Drawings. Locations shown on the Architectural Drawings shall govern over Mechanical and Electrical Drawings. Mechanical and Electrical items not clearly located will be located as directed by the Architect.
4. Dimensions indicated are taken between the faces of finished surfaces unless otherwise noted.
5. The Architect has not been retained for supervision of construction and assumes no responsibility for means, methods and sequence of construction.
6. These documents are not to be used for construction unless specifically noted for such purposes.

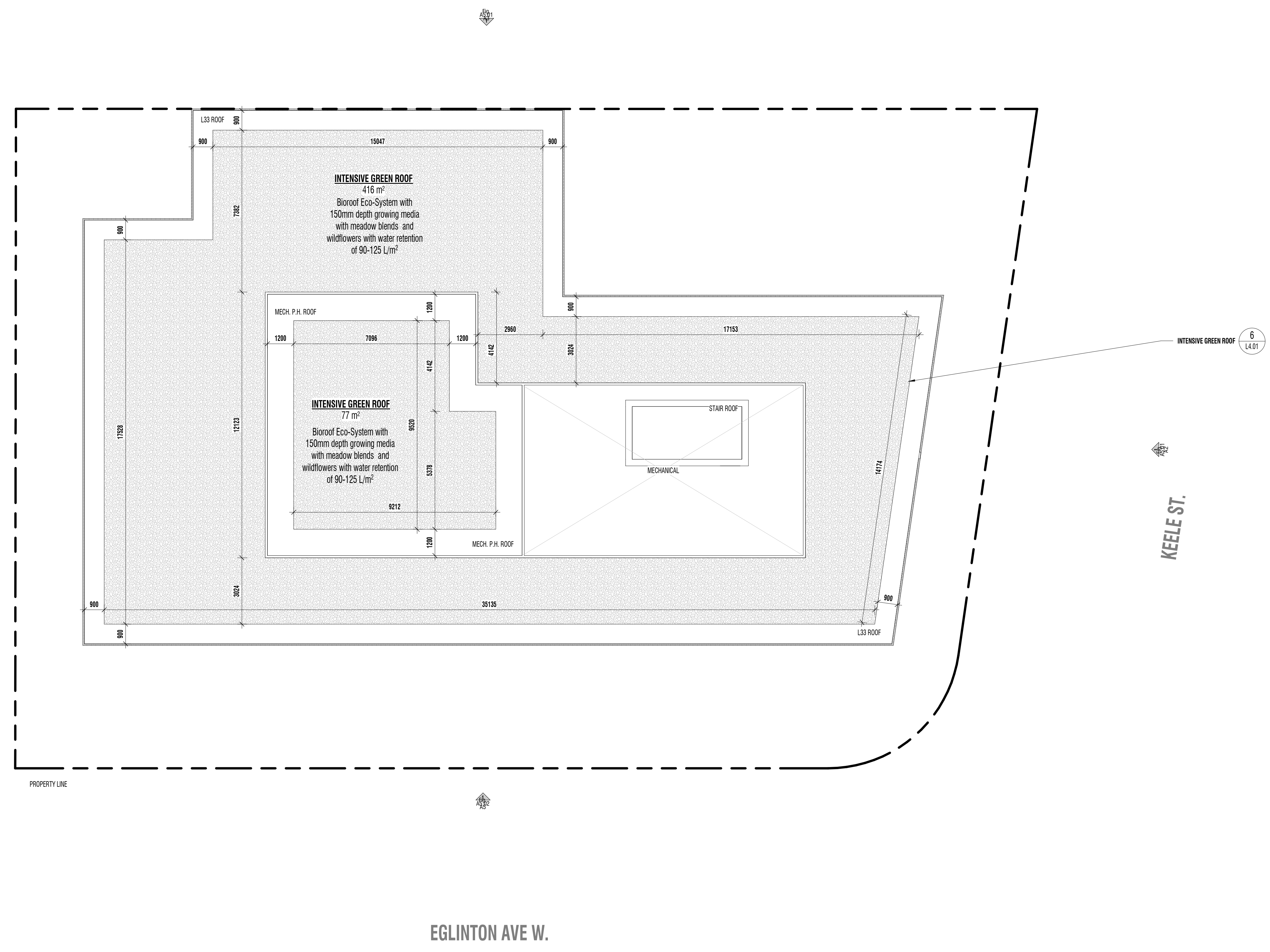

**1** Roof ZBA - LANDSCAPE  
L1.03 1:100

**PLANTING - PERRENIALS**

	TAG	COMMON NAME	BOTANICAL NAME	Size	CONDITION	QTY	REMARKS
LEVEL 1							
	AM	WHITE YARROW	ACHILLEA MILEFOLIUM	1 GAL.	CONT.	103	300mm O.C. DROUGHT TOLERANT; NATIVE SPECIES
	DC	TUFTED HAIR GRASS	DESCHAMPSIA CESPITOSA	2 GAL.	ALL	96	450mm O.C. DROUGHT TOLERANT; NATIVE SPECIES
	TC	CANADA YEW	TAXUS CANADENSIS	2 GAL.	CONT.	114	450mm O.C. DROUGHT TOLERANT; NATIVE SPECIES
LEVEL 4 (AMENITY)							
	TC	CANADA YEW	TAXUS CANADENSIS	2 GAL.	CONT.	190	450mm O.C. DROUGHT TOLERANT; NATIVE SPECIES
						503	

**HARDSCAPE AREAS**

	TYPE	AREA	REMARKS
LEVEL 1	Pavers	283.69'	SRI > 28; UNILOCK 3' X 12' PERMEABLE PAVER, ECO-PROMENADE, 'OPAL BLEND'
LEVEL 4 (AMENITY)	Terrace Pavers	401 m²	SRI > 28; UNILOCK 24' X 24' PAVER, ARCANIA, 'CORVARA'
		508 m²	
TOTAL		508 m²	

**SOFTSCAPE AREAS**

	TYPE	AREA
LEVEL 1	PLANTING BED	53 m²
LEVEL 4 (AMENITY)	PLANTING BED	52 m²
Mech. PH	R1-A 150 LIVE GREEN ROOF	416 m²
Roof	R1-A 150 LIVE GREEN ROOF	79 m²
		600 m²
TOTAL		600 m²

- HIGH-ALBEDO PAVERS  
SRI VALUE - 29 OR BETTER
- CONCRETE PAVING  
SRI VALUE - 29 OR BETTER
- CONCRETE PAVING  
SRI VALUE - 29 OR BETTER

Rev. Date Issued

**gh3\***  
305 EGLINTON AVE. EAST, 100  
TORONTO, ON, CANADA M4G 1Z9  
416 915 1191

**FORA**  
FORA  
2634, 2636, 2640, 2642 &  
2654 EGLINTON AVENUE  
WEST AND 1856 & 1856A  
KEELE STREET  
TORONTO, ONTARIO

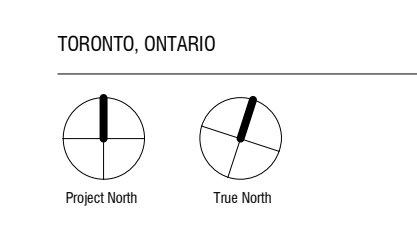

SCALE: As Indicated  
PROJECT NO.: 20202  
ISSUE DATE: DEC. 8, 2022

**LANDSCAPE ROOF PLAN**



Copyright is that of the Architect. Any version of this drawing reproduced by any means from any media without the written approval of the Architect is to be used for information only. The Architect will not be liable for any error or omission of information resulting from subsequent reproduction of the original drawing.

**GENERAL NOTES:**

1. Drawings are not to be scaled. Contractor will verify all existing conditions and dimensions required to perform the Work and will report any discrepancies with the Contract Documents to the Architect before commencing work.
2. The Architect's Drawings are to be read in conjunction with all other Contract Documents, including the Project Manual and the Electrical, Mechanical and Civil Drawings. In case of difference between the Contract Documents with respect to the quantity, location or nature of work, the greater shall apply.
3. Position of equipment as indicated on Mechanical and Electrical Drawings, Heating and Air Conditioning Drawings and Electrical Drawings shall govern over Mechanical and Electrical Drawings. Mechanical and Electrical items not clearly located will be located as directed by the Architect.
4. Dimensions indicated on drawings between the faces of finished surfaces unless otherwise noted.
5. The architect has not been retained for preparation of means, methods and sequence of construction.
6. These documents are not to be used for construction unless specifically noted for such purpose.

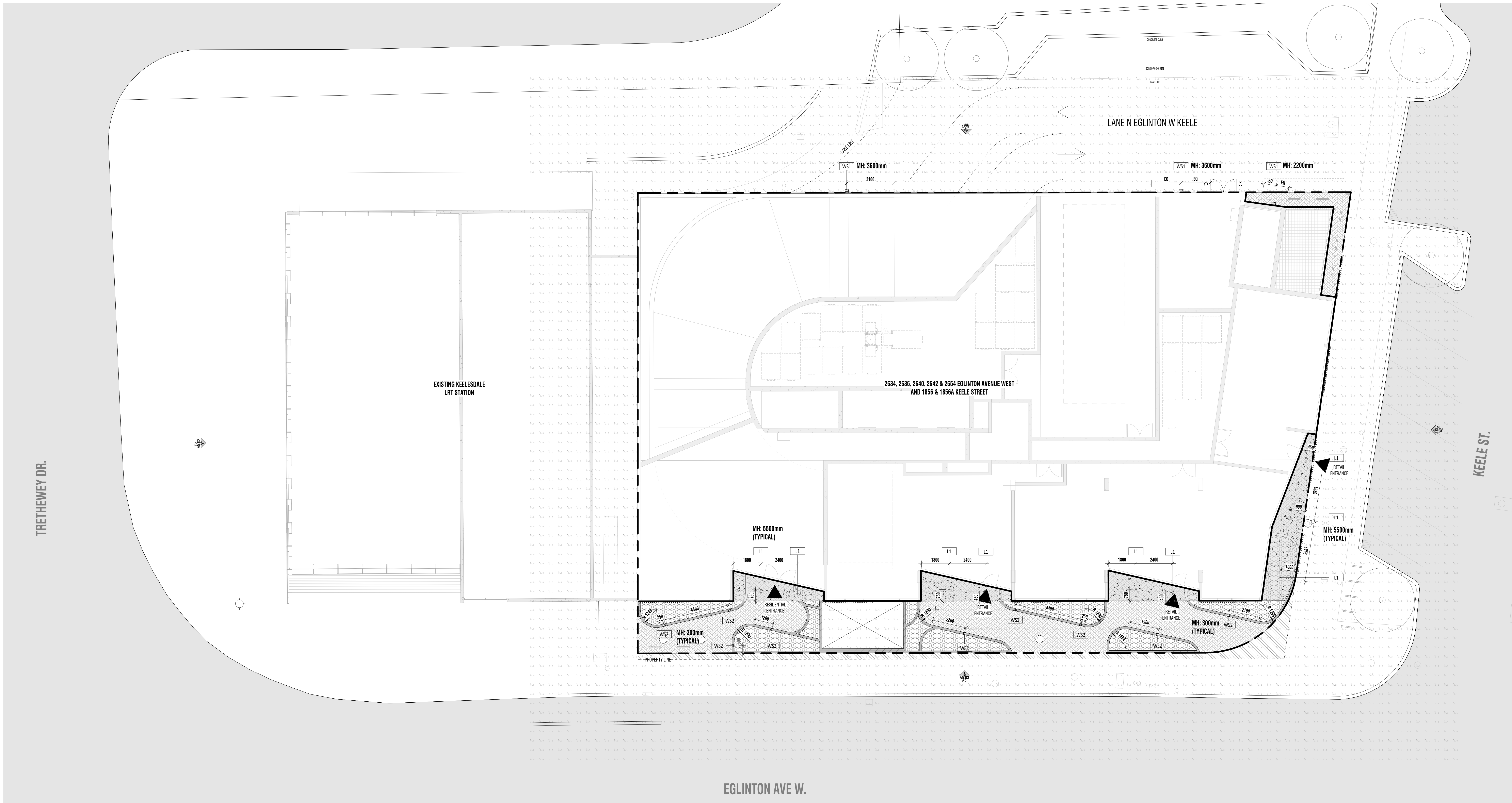

**1** Level 1 ZBA - LANDSCAPE LIGHTING  
LE1.01 1:100

**LIGHT FIXTURE SCHEDULE**

Type Mark	Type Comments	Count	Lamp
L1	LUMENCORE-NANO-DEEP_RECESS_BEZEL-HIGH OUTPUT_ROUND_TRIM	9	LED
WS1	TPL BEGA USA 22 383 - TYPE II	3	15 RW LED
WS2	BEGA RECESSED WALL LUMINAIRE	9	LED 4.8 W
<b>LEVEL 4 (AMENITY)</b>			
L1	LUMENCORE-NANO-DEEP_RECESS_BEZEL-HIGH OUTPUT_ROUND_TRIM	19	LED
WS2	BEGA RECESSED WALL LUMINAIRE	23	LED 4.8 W
<b>LEVEL 7</b>			
WS2	BEGA RECESSED WALL LUMINAIRE	7	LED 4.8 W
		<b>70</b>	

NOTE: SELECTED FIXTURES ARE FULL CUT-OFF AND HAVE A COLOUR TEMPERATURE EQUAL TO OR LESS THAN 3000K.

**WS1**

LED wall luminaire - wide spread light distribution

**WS2**

LED wall luminaire - wide spread light distribution

**WS1**

LED wall luminaire - wide spread light distribution

**WS2**

LED wall luminaire - wide spread light distribution

**WS1**

LED wall luminaire - wide spread light distribution

**WS2**

LED wall luminaire - wide spread light distribution

**L1**

downlights - lumencore

Specification Sheet

Project Name: [Redacted]

Type: [Redacted]

Beam	Beam Angle	Beam Diameter (mm)	Beam Area (sq. mm)	Beam Area (sq. ft.)	Beam Area (sq. in.)	Beam Area (sq. yd.)
1	24°	100	7850	0.12	0.01	0.00
2	36°	150	17700	0.27	0.02	0.00
3	48°	200	31400	0.47	0.03	0.00
4	60°	250	47100	0.68	0.05	0.00
5	72°	300	70700	1.03	0.07	0.00
6	84°	350	97400	1.42	0.10	0.00
7	96°	400	127200	1.87	0.13	0.00
8	108°	450	160400	2.40	0.17	0.00
9	120°	500	197000	2.93	0.21	0.00
10	132°	550	237000	3.55	0.26	0.00
11	144°	600	280400	4.27	0.31	0.00
12	156°	650	327300	5.09	0.37	0.00
13	168°	700	377700	5.99	0.44	0.00
14	180°	750	431600	6.98	0.51	0.00
15	192°	800	489000	8.07	0.58	0.00
16	204°	850	549900	9.26	0.66	0.00
17	216°	900	614400	10.56	0.74	0.00
18	228°	950	682500	11.97	0.83	0.00
19	240°	1000	755200	13.50	0.92	0.00
20	252°	1050	832500	15.16	1.02	0.00
21	264°	1100	914400	16.95	1.13	0.00
22	276°	1150	1000900	18.89	1.25	0.00
23	288°	1200	1092000	20.97	1.38	0.00
24	300°	1250	1188700	23.21	1.52	0.00
25	312°	1300	1291000	25.61	1.67	0.00
26	324°	1350	1398900	28.18	1.83	0.00
27	336°	1400	1512400	30.93	2.00	0.00
28	348°	1450	1631500	33.87	2.18	0.00
29	360°	1500	1756200	37.01	2.37	0.00

Specification Sheet

downlights - lumencore

Category	Item	Value
General	Manufacturer	lumencore
	Model	LS-150
	Finish	White
	Material	Aluminum
Mechanical	Mounting Height	150mm
	Beam Angle	24°
	Beam Diameter	100mm
	Beam Area	7850 sq. mm
Electrical	Power	15W
	Voltage	120V AC
	Current	0.125A
	Frequency	60Hz
Optical	CRI	90
	Color Temperature	3000K
	Beam Spread	24°
	Beam Diameter	100mm

Specification Sheet

downlights - lumencore

Category	Item	Value
General	Manufacturer	lumencore
	Model	LS-200
	Finish	White
	Material	Aluminum
Mechanical	Mounting Height	200mm
	Beam Angle	24°
	Beam Diameter	125mm
	Beam Area	15400 sq. mm
Electrical	Power	20W
	Voltage	120V AC
	Current	0.167A
	Frequency	60Hz
Optical	CRI	90
	Color Temperature	3000K
	Beam Spread	24°
	Beam Diameter	125mm

2 Oct 6, 2022 Coordination  
1 Sep 29, 2022 Coordination  
Rev. Date Issue

**gh3\***  
415 BLS 1191

**FORA**

2634, 2636, 2640, 2642 & 2654 EGLINTON AVENUE WEST AND 1856 & 1858A KEELE STREET

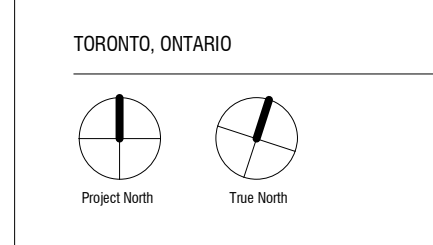

SCALE 1:100  
PROJECT NO. 202002  
ISSUE DATE DEC. 8, 2022

**GROUND FLOOR LIGHTING PLAN**

**LE1.01**

Copyright © 2022 of the Architect. Any reuse of this drawing reproduced by any means from any media without the written approval of the Architect is to be used for information only. The Architect will not be liable for any loss or damage of information resulting from subsequent reproduction of the original drawing.

**GENERAL NOTES:**

1. Drawings are not to be scaled. Contractor will verify all existing conditions and dimensions required to perform the Work and will report any discrepancies with the Contract Documents to the Architect before commencing work.
2. The Architect's Drawings are to be read in conjunction with all other Contract Documents including the Project Manual and the Division of Mechanical and Electrical Drawings. In case of difference between the Contract Documents with respect to the quantity, location or nature of work, the greater shall apply.
3. Positions of equipment, including Mechanical and Electrical Ductwork, Piping, and Riser are indicated on the Architectural Drawings. Location shown on the Architectural Drawings shall govern over Mechanical and Electrical Drawings. Mechanical and Electrical items not clearly located will be located as directed by the Architect.
4. Dimensions indicated on plans between the faces of finished surfaces unless otherwise noted.

The Architect has not been retained for preparation of construction and accuracy is responsibility of the owner, architect and contractor. These documents are not to be used for construction unless specifically noted for such purpose.

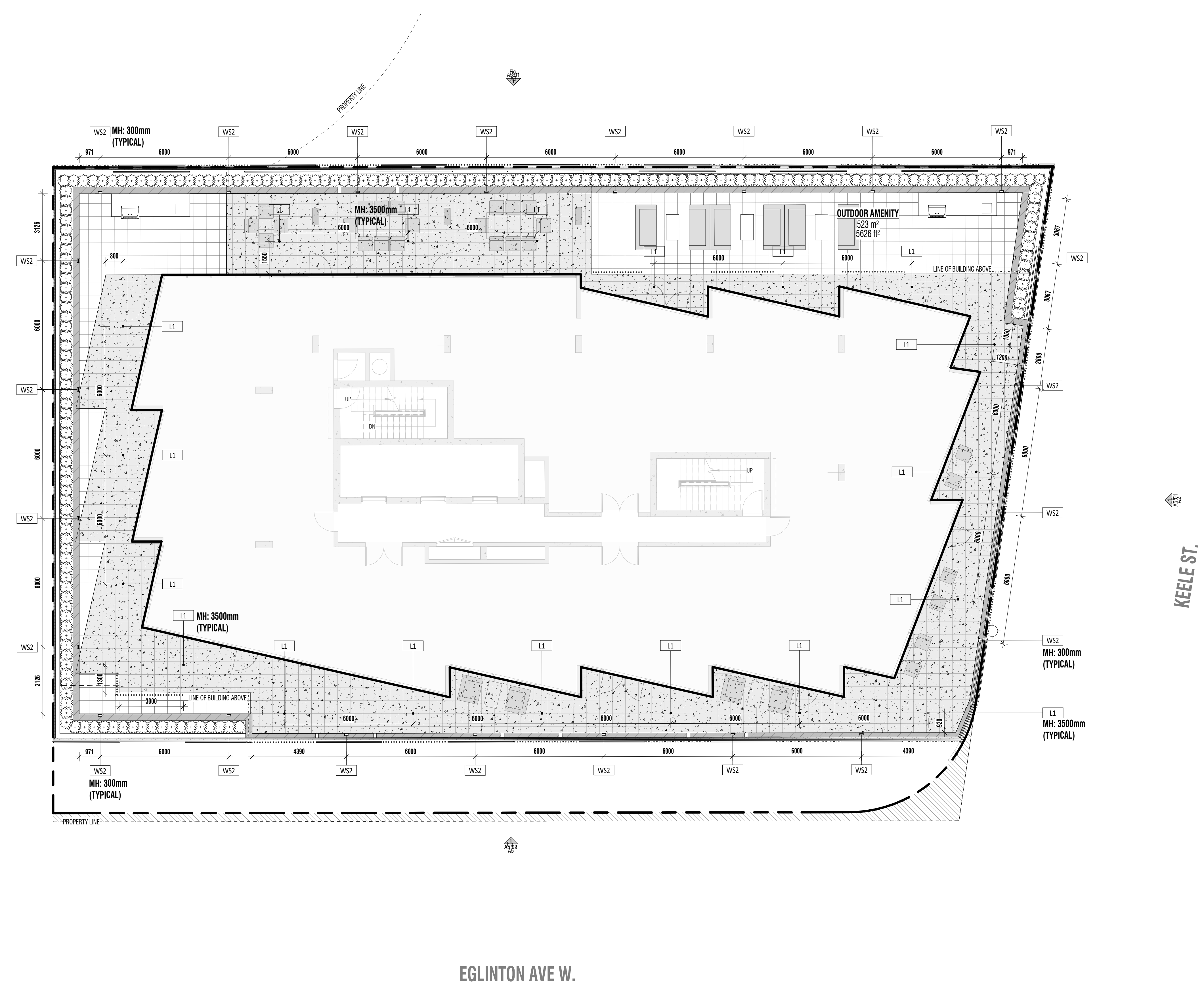

**1 LEVEL 4 (AMENITY) ZBA - LANDSCAPE LIGHTING**  
LE1.02 1:100

LIGHT FIXTURE SCHEDULE			
Type Mark	Type Comments	Count	Lamp
<b>LEVEL 1</b>			
L1	LUMENCORE-NANO-DEEP_RECESS_BEZEL-HIGH OUTPUT_ROUND_TRIM	9	LED
WS1	TPL BEGA USA 22 383 - TYPE II	3	15 BW LED
WS2	BEGA RECESSED WALL LUMINAIRE	9	LED 4.8 W
<b>LEVEL 4 (AMENITY)</b>			
L1	LUMENCORE-NANO-DEEP_RECESS_BEZEL-HIGH OUTPUT_ROUND_TRIM	19	LED
WS2	BEGA RECESSED WALL LUMINAIRE	23	LED 4.8 W
<b>LEVEL 7</b>			
WS2	BEGA RECESSED WALL LUMINAIRE	7	LED 4.8 W
		<b>70</b>	

NOTE: SELECTED FIXTURES ARE FULL CUT-OFF AND HAVE A COLOUR TEMPERATURE EQUAL TO OR LESS THAN 3000K.

**WS2**  
Recessed wall luminaire - shielded

**BEGA**

**Typical Product:**  
Project: [Blank]  
Model: [Blank]

**Application:** WS2 luminaire with shielded light distribution for glass front applications of ground surface, ceiling, entrance, lobby and atrium.

**Materials:** Cast aluminum housing and stainless steel trim. Clear or white glass lens with anti-glare coating. Clear or white glass lens with anti-glare coating. Clear or white glass lens with anti-glare coating.

**Finish:** [Blank]

**Lighting:** [Blank]

**Notes:** [Blank]

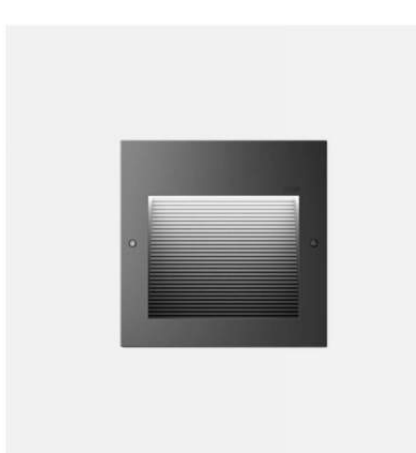

**L1**  
Specification Sheet

**downlights - lumencore**

**Project Name:** [Blank]  
**Type:** [Blank]



**Photometric Summary:**

Beam	Height	Beam Dia	Beam Angle	Beam Dia @ 1m	Beam Dia @ 2m	Beam Dia @ 3m	Beam Dia @ 4m	Beam Dia @ 5m	Beam Dia @ 6m	Beam Dia @ 7m	Beam Dia @ 8m	Beam Dia @ 9m	Beam Dia @ 10m
1	1.0	100	10	100	200	300	400	500	600	700	800	900	1000

**Features:** [Blank]

**Electrical and control:** [Blank]

**Physical:** [Blank]

**Optics:** [Blank]

**Substrate and temperature:** [Blank]

**Scenes:** [Blank]

**Configuration:** [Blank]

**lumencore**

**Specification Sheet**

**downlights - lumencore**

Item No.	Quantity	Unit	Description	Notes
1	1	ea	Downlight luminaire	

**lumencore**

**Specification Sheet**

**downlights - lumencore**

Item No.	Quantity	Unit	Description	Notes
1	1	ea	Downlight luminaire	

**lumencore**

3 Oct. 26.22 Coordination  
2 Oct. 6.22 Coordination  
1 Sep. 29.22 Coordination

**gh3\***  
415 BLS 1191

**FORA**  
2634, 2636, 2640, 2642 & 2654 EGLINTON AVENUE WEST AND 1856 & 1858A KEELE STREET

TORONTO, ONTARIO  
Project North  
True North

SCALE 1:100  
PROJECT NO. 202002  
ISSUE DATE DEC. 8, 2022

**L4 FLOOR LIGHTING PLAN**

**LE1.02**



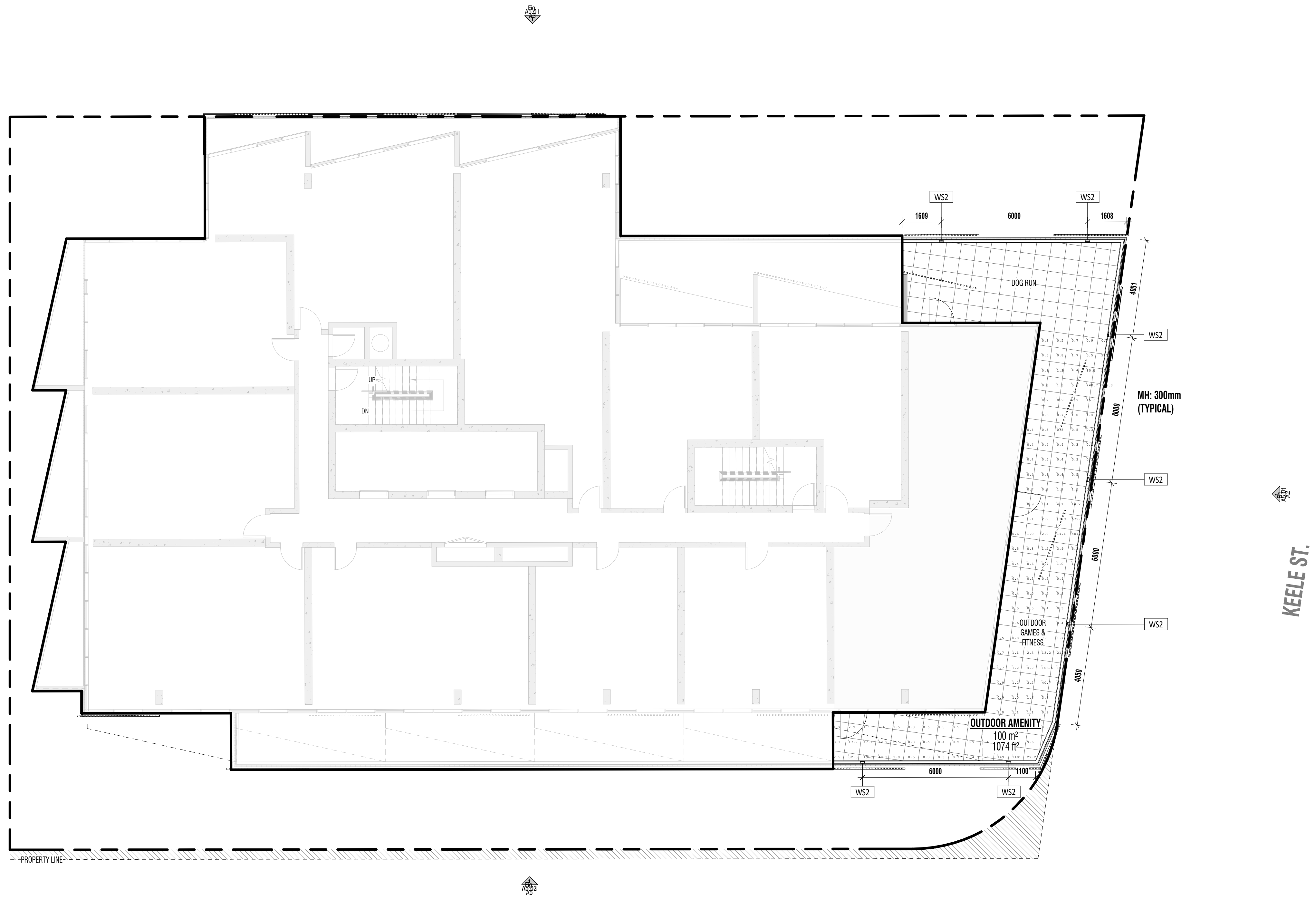

EGLINTON AVE. W.

KEELE ST.

1 LEVEL 7 ZBA - LANDSCAPE LIGHTING  
LE1.03 1:100

WS2

Recessed wall luminaire - shielded

BEGA

Type: BEGA Product: Modified:

**Application:** Recessed wall luminaires with shielded light distribution for glare free illumination of ground surfaces, building entrances, stairs and pathways.

**Materials:** Luminaires housing and fixtures constructed of die-cast anodized aluminum alloy. Clear safety glass with radial fracture. Silicone applied robotically to casting, plasma treated for increased adhesion. High temperature silicone gaskets. Mechanically custom stainless steel fasteners. Stainless steel screw (F8).

**Construction:** Cast aluminum housing. MEET: meet the North American Standards, suitable for wall location. Protection class: IP30.

**Weight:** 3.3 lbs.

**Electrical:** Operating voltage: 100-277VAC  
Minimum ambient temperature: 20°C  
LED max wattage: 4.8 W  
LED max voltage: 7.2 V  
Current rating: 0.75A maximum  
Color rendering index: Ra: 90  
LED service life (L70): 40,000 hours (40,000)  
LED service life (L80): 50,000 hours

**LED color temperature:**  
0200K - Product number = **#6**  
0300K - Product number = **#38**  
0400K - Product number = **#5**  
0700K - Product number = **#27**  
BEGA are ready to supply you with custom LED replacement module for up to 20 years after the purchase of LED luminaires - see website for details.

**Finish:**  
BEGA standard finishes are matte, baked powder coat with minimum 60° gloss. BEGA standard finish: 60° gloss powder coating provides superior rust protection in black, bronze, and silver. BEGA standard finishes, as well as specially available finishes, and custom colors, are a powdercoat product.

Available colors: X Black (BLK) L White (WHT) C-RAL  
C-Black (BLK) C-Silver (SLV) C-CUS

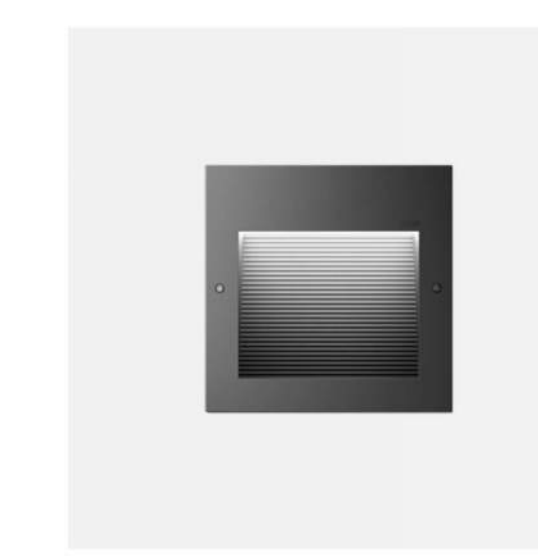
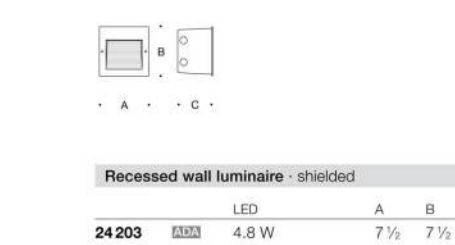

LIGHT FIXTURE SCHEDULE

Type Mark	Type Comments	Count	Lamp
LEVEL 1			
L1	LUMINCORE-NANO-DEEP_RECESS_BEZEL_HIGH OUTPUT_ROUND_TRIM	9	LED
WS1	TPL BEGA USA 22 383 - TYPE II	3	15.8W LED
WS2	BEGA RECESSED WALL LUMINAIRE	9	LED 4.8 W

LEVEL 4 (AMENITY)

L1	LUMINCORE-NANO-DEEP_RECESS_BEZEL_HIGH OUTPUT_ROUND_TRIM	19	LED
WS2	BEGA RECESSED WALL LUMINAIRE	23	LED 4.8 W

LEVEL 7

WS2	BEGA RECESSED WALL LUMINAIRE	7	LED 4.8 W
		<b>70</b>	

NOTE: SELECTED FIXTURES ARE FULL CUT-OFF AND HAVE A COLOUR TEMPERATURE EQUAL TO OR LESS THAN 3000K.

3 Oct.16.22 Coordination  
2 Oct.6.22 Coordination  
1 Sep.19.22 Coordination

gh3\*  
35 GERRARD AVE. EAST, 100  
TAMMIL, ON, CANADA M2J 2Y9  
416 915 1191

FORA  
2634, 2636, 2640, 2642 &  
2654 EGLINTON AVENUE  
WEST AND 1856 & 1858A  
KEELE STREET

TORONTO, ONTARIO  
Project North  
Task South

SCALE 1:100  
PROJECT NO. 202002  
ISSUE DATE DEC 8, 2022

L7 FLOOR  
LIGHTING PLAN

LE1.03